

FORM B - BUILDING

MASSACHUSETTS HISTORICAL COMMISSION
Office of the Secretary, State House, Boston

In Area no. A	Form no. 27
------------------	----------------

2.



1. Town North Reading

Address 19 Willow Street

Name Burditt House

Present use residence

Present owner Mr. & Mrs. Dana A. Rowe, Jr.

3. Description:

Date 1901

Source N. R. Assessor's Records

Style Queen Anne

Architect _____

Exterior wall fabric wood

Outbuildings (describe) garage, greenhouse

Other features _____

Altered _____ Date _____

Moved _____ Date _____

5. Lot size: 29,500 sq. ft.

One acre or less Over one acre _____

Approximate frontage 260'

Approximate distance of building from street
60'

6. Recorded by Meredith M. Turner

Organization Historical Commission

Date June 1978

4. Map. Draw sketch of building location in relation to nearest cross streets and other buildings. Indicate north.

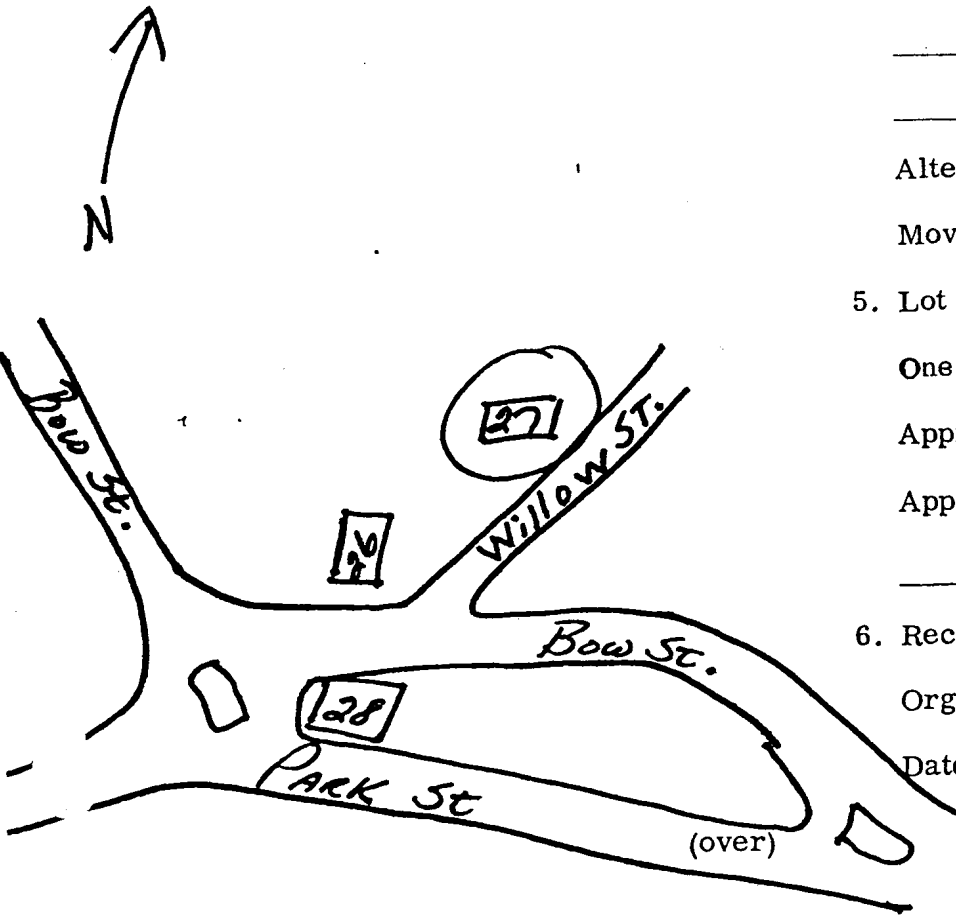

7. Original owner (if known) Mary E. Cleveland, wife of Llewellyn Cleveland

Original use dwelling

Subsequent uses (if any) and dates _____

8. Themes (check as many as applicable)

Aboriginal	_____	Conservation	_____	Recreation	_____
Agricultural	_____	Education	<u> x </u>	Religion	_____
Architectural	<u> x </u>	Exploration/ settlement	_____	Science/ invention	_____
The Arts	_____	Industry	_____	Social/ humanitarian	_____
Commerce	_____	Military	_____	Transportation	<u> x </u>
Communication	_____	Political	<u> x </u>		
Community development	<u> x </u>				

9. Historical significance (include explanation of themes checked above)

Purchased by Arthur A. Burditt in 1905 and sold by the heirs of the Burditts in 1969. Burditt in his youth was a stage coach driver and later was employed by Carpenter & French Store. He served the town as call police officer for over 50 years, Cemetery Commissioner and Trustee of Trust Funds. His wife, Blanche (Whittredge) Burditt, served on the School Committee for many years.

The architectural style is unique to the Town's center since it remains exactly as it looked when it was built.

NOTE: The photo was taken when insulation was being installed.

10. Bibliography and/or references (such as local histories, deeds, assessor's records, early maps, etc.)

Mdd1s~~g~~ s.. s. Registry of Deeds and Probate
N. R. Assessor's Records
Interviews with Shirley Hoyt and Ruth (Burditt) Kinnie
N. R. Town Reports