

In Area no.	Form no.
A	57

2.



1. Town North Reading

Address 168 Park Street

Name Bay-Bank Middlesex

Present use Bank

Present owner Bay/Bank Middlesex

3. Description:

Date 1973-74

Source N. R. Assessor's Records

Style Civic Georgian

Architect \_\_\_\_\_

Exterior wall fabric brick

Outbuildings (describe) \_\_\_\_\_

Other features \_\_\_\_\_

Altered \_\_\_\_\_ Date \_\_\_\_\_

Moved \_\_\_\_\_ Date \_\_\_\_\_

5. Lot size: 28,788 sq. ft.

One acre or less  Over one acre \_\_\_\_\_

Approximate frontage 150'

Approximate distance of building from street  
50'

6. Recorded by Madge Nickerson

Organization Historical Commission

Date June 1978

4. Map. Draw sketch of building location in relation to nearest cross streets and other buildings. Indicate north.

← NORTH

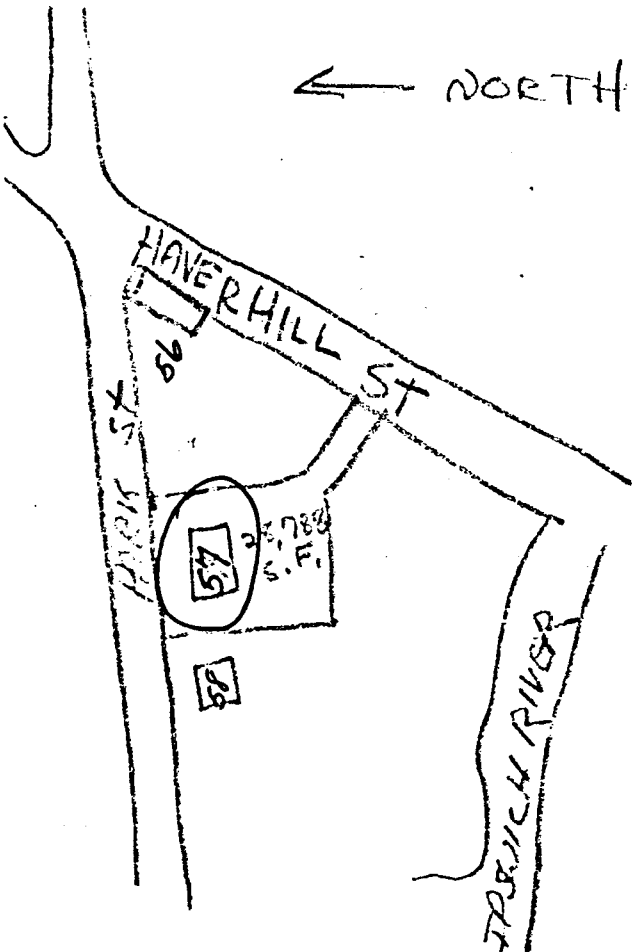

(over)

7. Original owner (if known) Bay/Bank Middlesex, building only; land owned by  
William H. Ryer, Jr.

Original use \_\_\_\_\_

Subsequent uses (if any) and dates \_\_\_\_\_

8. Themes (check as many as applicable)

Aboriginal	_____	Conservation	_____	Recreation	_____
Agricultural	_____	Education	_____	Religion	_____
Architectural	_____	Exploration/ settlement	_____	Science/ invention	_____
The Arts	_____	Industry	_____	Social/ humanitarian	_____ )
Commerce	_____	Military	_____	Transportation	_____ )
Communication	_____	Political	_____		
Community development	_____				

9. Historical significance (include explanation of themes checked above)

10. Bibliography and/or references (such as local histories, deeds, assessor's records, early maps, etc.)

Mddlsx s. s. Registry Deeds and Probate  
North Reading Assessor's Records